



**KENTUCKY EXPOSITION CENTER**  
A WORLD-CLASS VENUE FOR YOUR TOP-NOTCH EVENT  
LOUISVILLE, KENTUCKY

KENTUCKY EXPOSITION CENTER  
NOW YOU HAVE ACCESS TO AN EXCITING EVENT VENUE UNLIKE ANY OTHER

UNMATCHED FACILITIES FOR UNBEATABLE EXPOSURE

- 1.3 MILLION SQUARE FEET OF FLEXIBLE EXHIBIT SPACE
- 2,000 ROOMS WITHIN WALKING DISTANCE
- 300 ACRES OF OUTDOOR EXHIBIT AND DEMONSTRATION SPACE
- LOW-COST EVENT STAGING
- MAJOR INTERSTATE ROUTING WITH DIRECT ACCESS FROM  
I-65 AND I-264 AND QUICK CONNECTS TO I-64 AND I-71
- ALSO ON PROPERTY  
FREEDOM HALL COLISEUM    BROADBENT ARENA    SIX FLAGS KENTUCKY KINGDOM



LOUISVILLE - ATTRACTIVE FROM EVERY ANGLE  
ONCE YOU STEP OUTSIDE THE EXPOSITION CENTER,  
YOU'LL DISCOVER THAT LOUISVILLE OFFERS ENOUGH  
ATTRACTIONS AND UNIQUE POINTS OF INTEREST TO KEEP  
EVERYONE ENTERTAINED.

**WITHIN JUST A FEW MINUTES' WALK OR A 5-MINUTE DRIVE OF THE EXPOSITION CENTER:**

- Churchill Downs, America's legendary racetrack and home of the Kentucky Derby and the Kentucky Derby Museum
- Six Flags Kentucky Kingdom Thrill Park, a full-scale amusement park on property
- Glassworks houses 50 glass artists who can be viewed creating their works of art; open daily for tours and special events
- Kentucky Center for African American Heritage
- Muhammad Ali Center
- Frazier International History Museum
- Kentucky International Convention Center
- A variety of shopping malls, restaurants, cineplexes, and more hotel rooms at every price level

**WITHIN A 15- TO 20-MINUTE DRIVE OF THE EXPOSITION CENTER:**

- The Louisville Slugger Bat Factory and Museum (Main Street), home of the legendary Louisville Slugger baseball bat
- The Louisville Science Center and IMAX theater (Main Street) provide fun and discovery for inquiring minds of all ages
- The Kentucky Museum of Arts and Design (Main Street) offers fine examples of Kentucky's arts and crafts
- The Belle of Louisville (Fourth Street Wharf near the Galt House Hotel) is a restored 1800s working paddle wheel steamboat with daily cruises along the Ohio River
- The Louisville Zoo now features the exciting new four-acre Gorilla Forest, a multifaceted natural habitat that's home to 12 western lowland gorillas
- Fourth Street Live, a \$70 million downtown complex of restaurants, coffee shops, bars, nightclubs and other entertainment venues
- The Kentucky Center for the Arts, the Louisville Ballet, Actor's Theatre of Louisville, The Louisville Orchestra and The Kentucky Opera host cultural and performing arts events
- One of the region's most unique antique malls is on Market Street, plus contemporary art galleries and dining in a newly revitalized area
- Slugger Field, home of Louisville's AAA baseball franchise and farm team for the Cincinnati Reds, is open to catch a game
- Across the Ohio River is Caesars Indiana, the world's largest riverboat gambling venue; open 24 hours
- A wealth of restaurants around downtown offer everything from five-star dining to distinctive local favorites

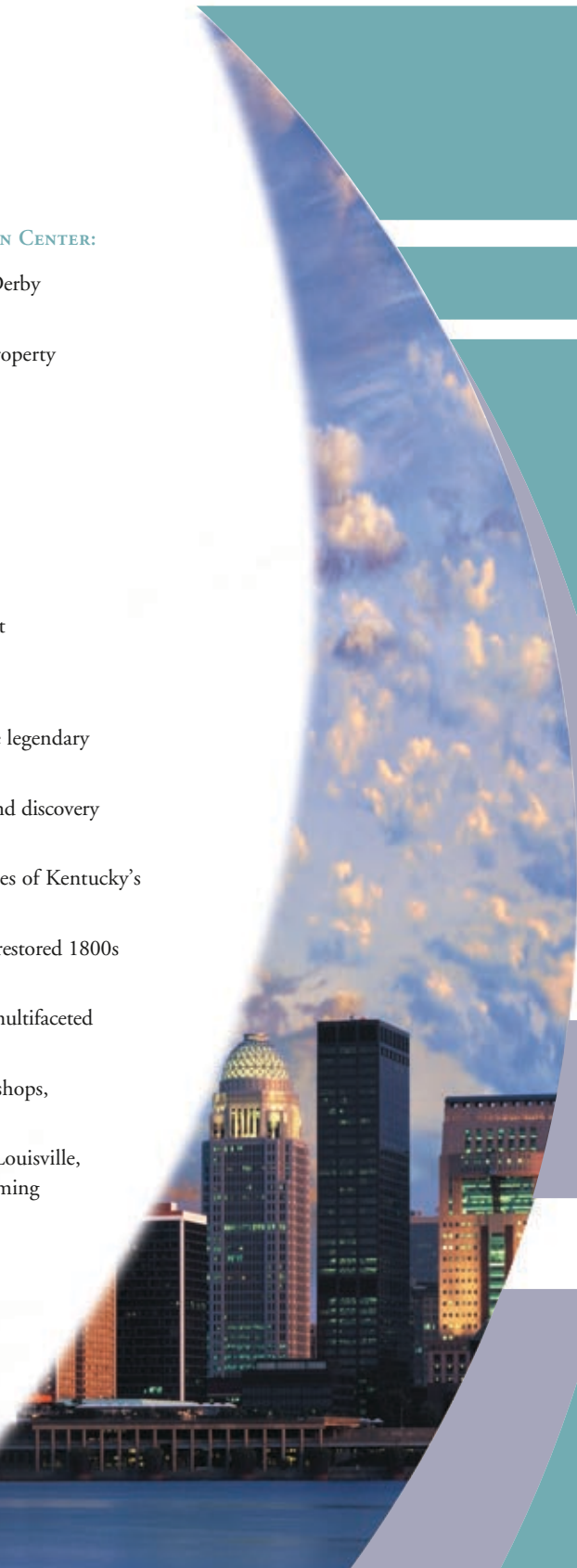

IT COULDN'T GET EASIER TO GET AROUND

- At the hub of several major interstates and within driving distance of more than half of the U.S. population
- Louisville International Airport with service from 16 major carriers is less than 5 minutes away
  - 14,000 affordable hotel rooms, 5,000 of them within just a few minutes' drive
- Easy access, minimal cab fares, a range of low-cost hotels and a world-class venue

CARING WARMTH OF GENUINE HOSPITALITY

- Visitors to Louisville receive an outstanding degree of friendliness and helpfulness
  - Experienced staff offer top-notch service and commitment to seamless support
- Guaranteed to make events a success for attendees and practically painless for organizers

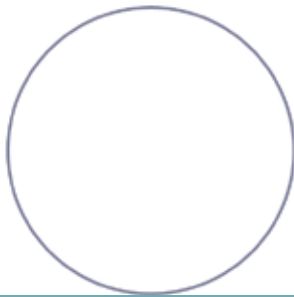
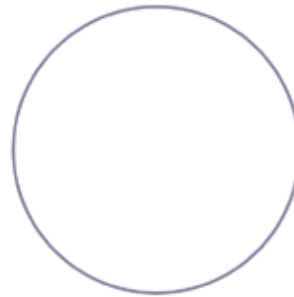



# C A P A B I L I T I E S

## CAPABILITIES AS DIVERSE AS THE EVENTS

Every week the Kentucky Exposition Center is at the heart of an amazing spectrum of activities that span work, life and entertainment. So perhaps the best way to illustrate our capabilities is to show you – to give you a partial list of the events we've hosted, or continue to host, on a regular basis:

- National Recreational Vehicle Industry Association Trade Show
  - The Mid-America Trucking Show
- International Construction & Utility Equipment Expo
  - GIE/Expo!
  - The Street Rod Nationals
- Midwest Manufactured Housing Federation Expo
  - National Quartet Convention
  - National FFA Convention
  - The Great North American RV Rally
  - National Farm Machinery Expo
  - North American International Livestock Expo
    - SkillsUSA
  - American Public Works Association
- International Association of Fire Chiefs
  - National Houseboat Expo
- USA Volleyball Girls and Boys Junior Olympic Nationals
  - Church of God of Prophecy
  - National Fishing Lure Collectors Club
  - Pumper & Cleaner Expo

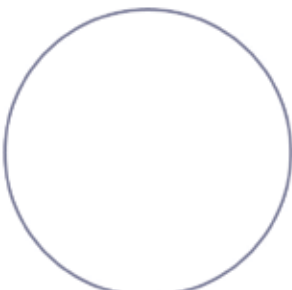
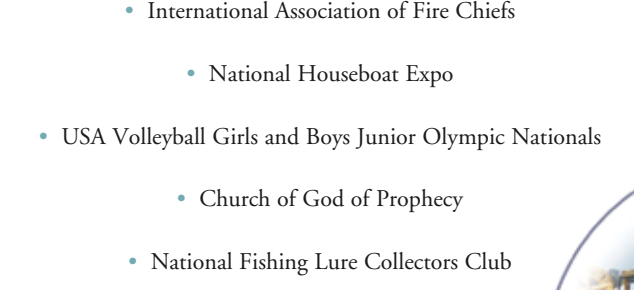

KENTUCKY EXPOSITION CENTER  
 NOW YOU HAVE ACCESS TO AN EXCITING EVENT VENUE UNLIKE ANY OTHER

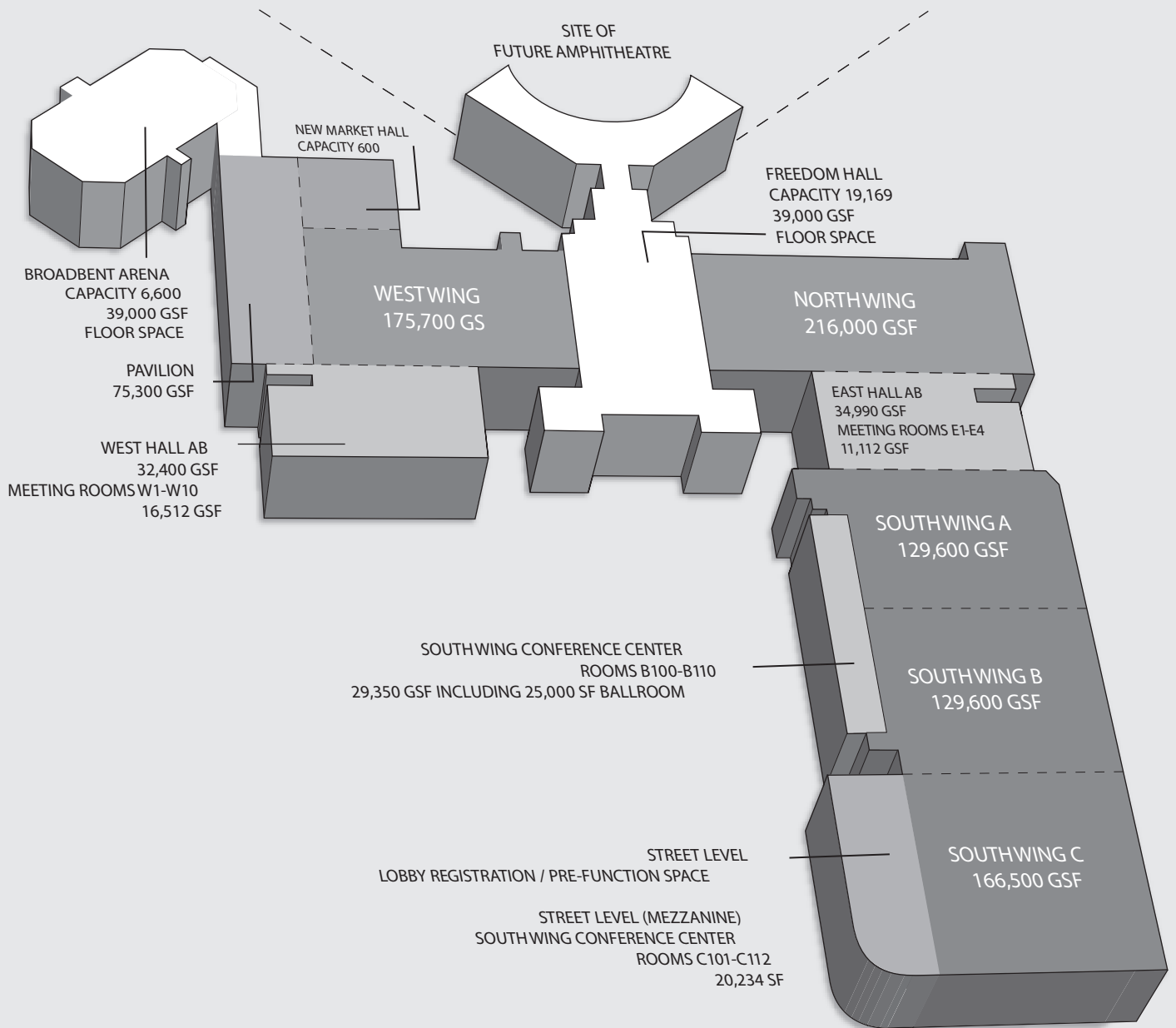

TO SEE DETAILED SPACE SPECIFICATIONS AND DIAGRAMS FOR EXHIBITS AND MEETINGS, PLEASE LOG ONTO [WWW.KYEXPO.ORG](http://WWW.KYEXPO.ORG).

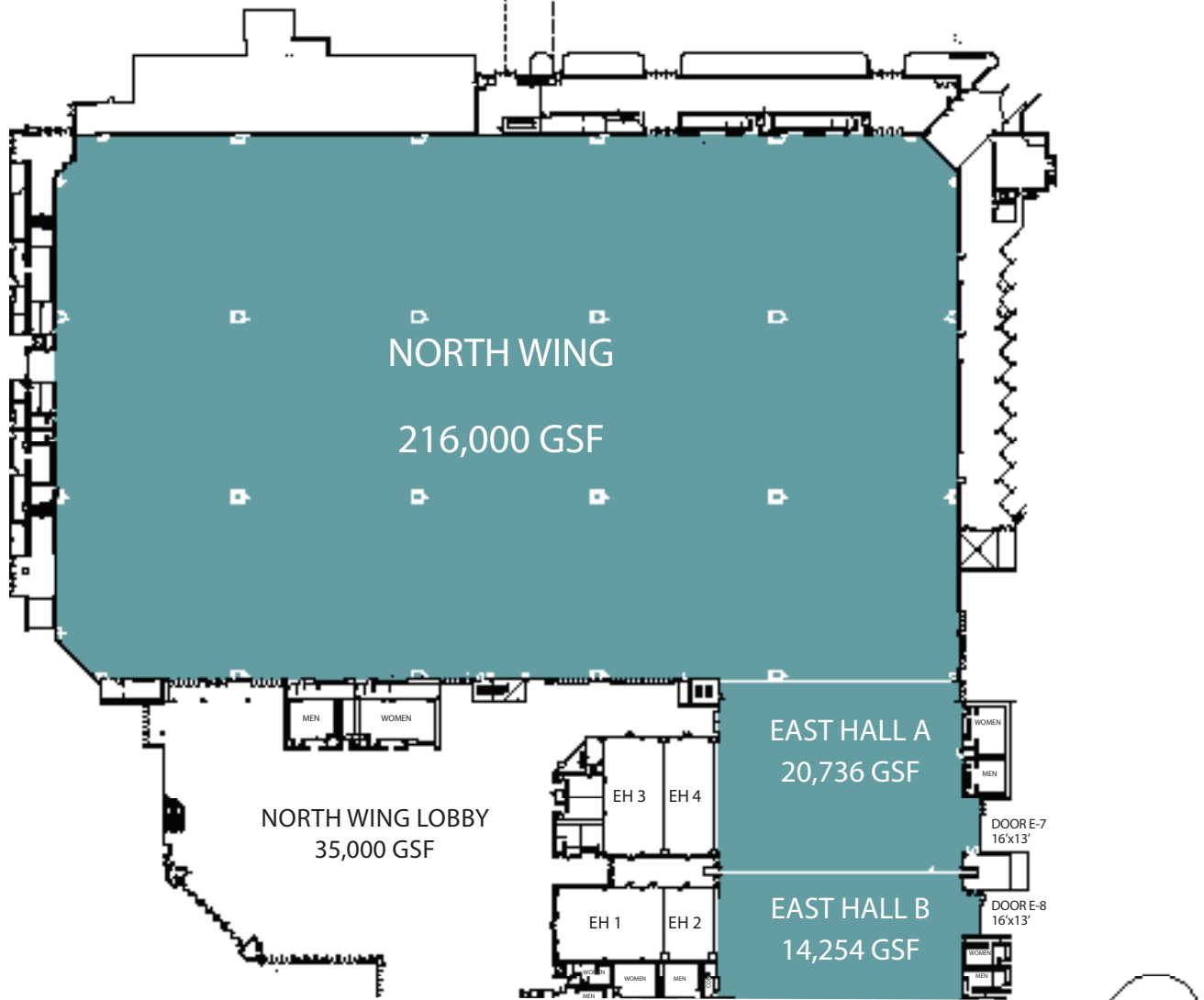

	DIMENSIONS	TOTAL GSF	CEILING HEIGHT	THEATER STYLE	CLASSROOM/ BANQUET	10' X 10' BOOTHS
North Wing	362' x 603'	216,000	27'	13,700	12,000	1,134
North Wing Lobby	NA	35,000	60'	NA	NA	NA
East Hall A	128' x 162'	20,736	23'	2,400	1,213	98
East Hall B	88' x 162'	14,254	23'	1,200	934	75
East Hall AB	216' x 162'	34,990	23'	3,600	2,147	173
E1	48' x 74'	3,552	16'	507	237	20
E2	48' x 34'	1,632	16'	49	49	10
E3	38' x 78'	2,964	16'	423	198	14
E4	38' x 78'	2,964	16'	423	198	14
E1 - 2	48' x 108'	5,184	16'	740	346	30
E3 - 4	76' x 78'	5,928	16'	846	396	28

Floor load of North Wing and East Halls A & B is 800 lbs. per square foot. Approximate GSF listed.

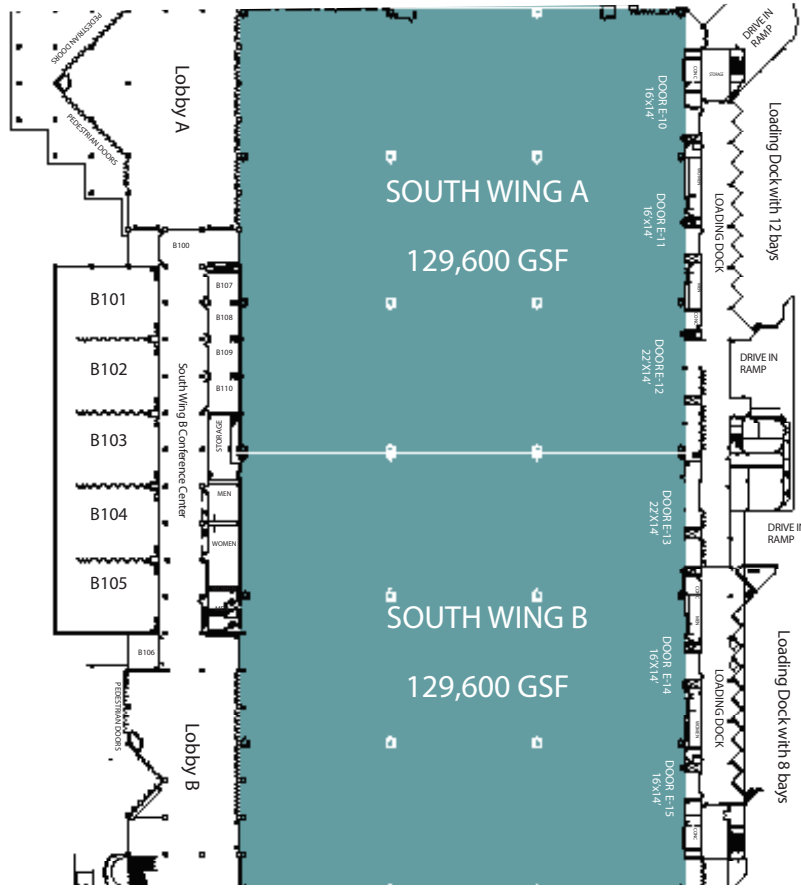

SOUTH WING A & B	DIMENSIONS	TOTAL GSF	CEILING HEIGHT	THEATER STYLE	CLASSROOM/ BANQUET	10' X 10' BOOTHS
South Wing A	360' x 360'	129,600	27'	14,109	8,666	700
South Wing B	360' x 360'	129,600	27'	13,963	8,666	700
South Wings AB	360' x 720'	259,200	27'	28,072	17,332	1,400
SWA Lobby	Varies	23,800	64' max	NA	NA	NA
SWB Lobby	Varies	13,500	52' max	NA	NA	NA
B100	24' x 29'	715	14'	100	45	NA
B101	59' x 84'	5,000	21'	500	333	NA
B102	60' x 84'	5,000	21'	500	333	NA
B103	60' x 84'	5,000	21'	500	333	NA
B104	60' x 84'	5,000	21'	500	333	NA
B105	59' x 84'	5,000	21'	500	333	NA
B106	24' x 29'	715	14'	100	45	NA
B107	25' x 25'	635	9'4"	90	42	NA
B108	25' x 30'	765	9'4"	105	50	NA
B109	25' x 30'	765	9'4"	105	50	NA
B110	25' x 29'	755	9'4"	105	50	NA
B101 – 105	84' x 298'	25,000	21'	2,500	1,665	NA
B107 – 108	25' x 55'	1,400	9'4"	195	90	NA
B109 – 110	25' x 59'	1,520	9'4"	210	100	NA
B107 – 110	25' x 114'	2,920	9'4"	405	190	NA

Floor load South Wings A & B = 800 lbs/square foot. Approximate GSF listed.



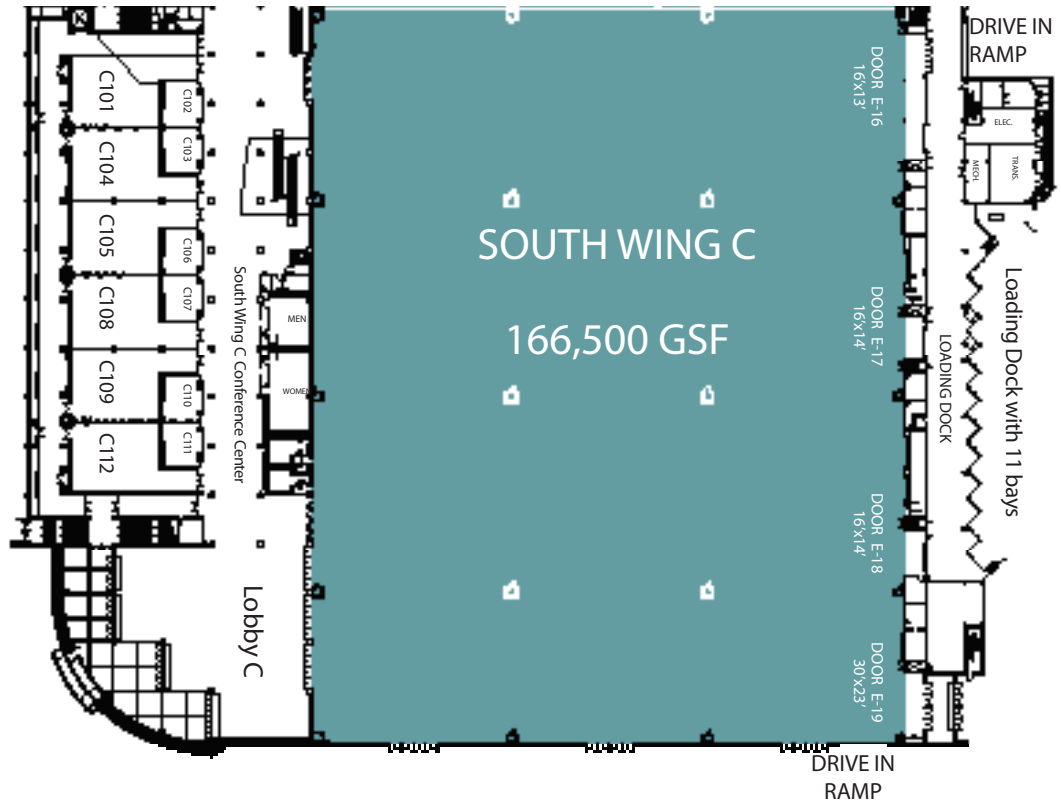

	DIMENSIONS	TOTAL GSF	CEILING HEIGHT	THEATER STYLE	CLASSROOM/ BANQUET	10' X 10' BOOTHS
SWC	360' x 450'	166,500	27'	10,860	10,860	875
South Wing C Lobby	Varies	13,423	58' max	NA	NA	NA
South Wings ABC	360' x 1,170'	425,700	27'	38,932	28,192	2,275
C101	43' x 55'	2,719	16'	342	160	NA
C102	28' x 20'	590	12'	84	40	NA
C103	28' x 20'	590	12'	84	40	NA
C104	44' x 55'	2,814	16'	350	164	NA
C105	44' x 55'	2,814	16'	350	164	NA
C106	28' x 20'	590	12'	84	40	NA
C107	28' x 20'	590	12'	84	40	NA
C108	44' x 55'	2,814	16'	350	164	NA
C109	44' x 55'	2,814	16'	350	164	NA
C110	28' x 20'	590	12'	84	40	NA
C111	28' x 20'	590	12'	84	40	NA
C112	43' x 55'	2,719	16'	342	160	NA
C101 - 104	87' x 55'	5,533	16'	692	324	NA
C105 - 108	88' x 55'	5,628	16'	700	328	NA
C109 - 112	87' x 55'	5,533	16'	692	324	NA
C102 - 103	56' x 20'	1,180	12'	168	80	NA
C106 - 107	56' x 20'	1,180	12'	168	80	NA
C110 - 111	56' x 20'	1,180	12'	168	80	NA
C201	51' x 77'	4,006	21'	572	267	NA
C202	52' x 77'	4,038	21'	576	269	NA
C203	60' x 77'	4,659	21'	665	310	NA
C204	52' x 77'	4,038	21'	576	269	NA
C205	51' x 77'	4,006	21'	572	267	NA
C201 - 205	266' x 77'	20,747	21'	2,961	1,382	NA

Floor load South Wing C = 800 lbs./square foot. Approximate GSF listed.

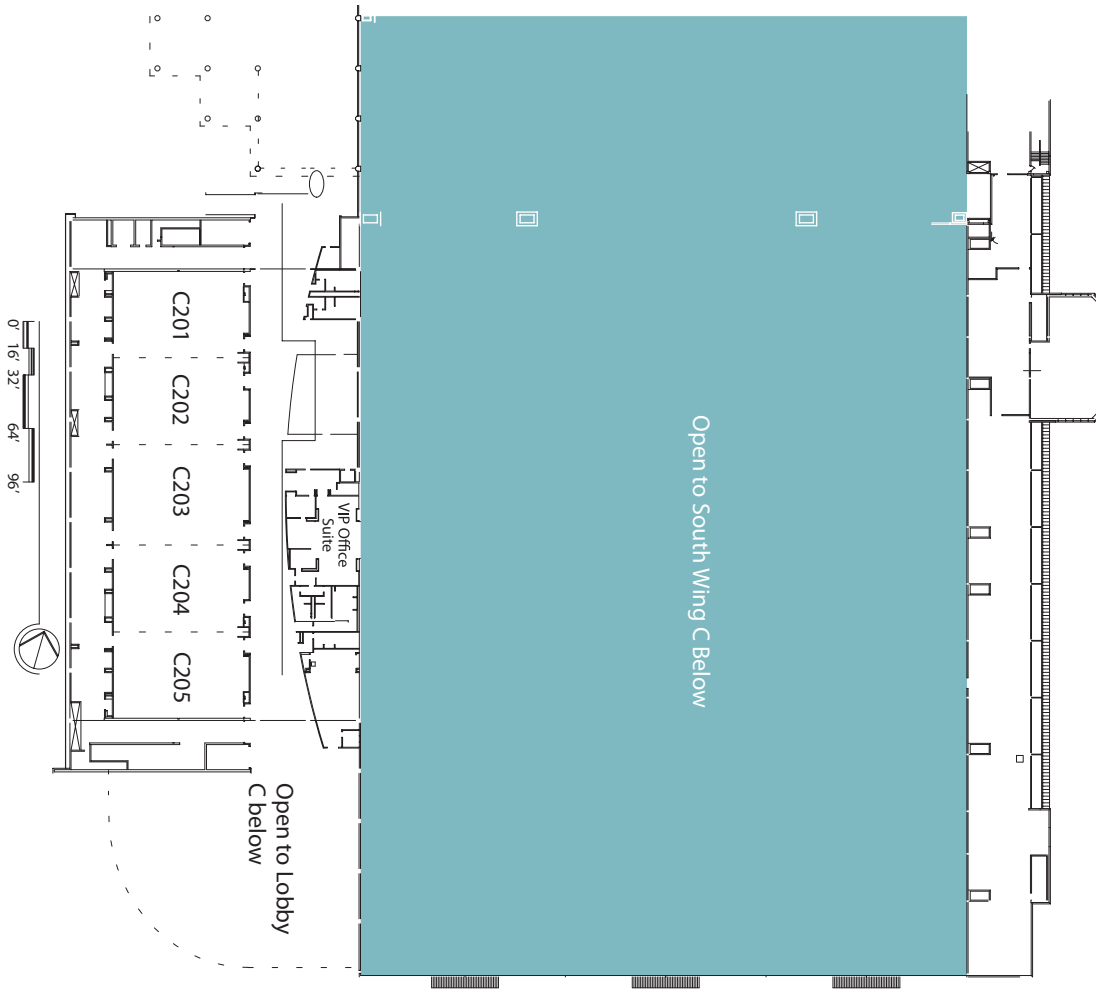

	DIMENSIONS	TOTAL GSF	CEILING HEIGHT	THEATER STYLE	CLASSROOM/ BANQUET	10' X 10' BOOTHS
SWC	360' x 450'	166,500	27'	10,860	10,860	875
South Wing C Lobby	Varies	13,423	58' max	NA	NA	NA
South Wings ABC	360' x 1,170'	425,700	27'	38,932	28,192	2,275
C101	43' x 55'	2,719	16'	342	160	NA
C102	28' x 20'	590	12'	84	40	NA
C103	28' x 20'	590	12'	84	40	NA
C104	44' x 55'	2,814	16'	350	164	NA
C105	44' x 55'	2,814	16'	350	164	NA
C106	28' x 20'	590	12'	84	40	NA
C107	28' x 20'	590	12'	84	40	NA
C108	44' x 55'	2,814	16'	350	164	NA
C109	44' x 55'	2,814	16'	350	164	NA
C110	28' x 20'	590	12'	84	40	NA
C111	28' x 20'	590	12'	84	40	NA
C112	43' x 55'	2,719	16'	342	160	NA
C101 – 104	87' x 55'	5,533	16'	692	324	NA
C105 – 108	88' x 55'	5,628	16'	700	328	NA
C109 – 112	87' x 55'	5,533	16'	692	324	NA
C102 – 103	56' x 20'	1,180	12'	168	80	NA
C106 – 107	56' x 20'	1,180	12'	168	80	NA
C110 – 111	56' x 20'	1,180	12'	168	80	NA
C201	51' x 77'	4,006	21'	572	267	NA
C202	52' x 77'	4,038	21'	576	269	NA
C203	60' x 77'	4,659	21'	665	310	NA
C204	52' x 77'	4,038	21'	576	269	NA
C205	51' x 77'	4,006	21'	572	267	NA
C201 – 205	266' x 77'	20,747	21'	2,961	1,382	NA

Floor load South Wing C = 800 lbs./square foot. Approximate GSF listed.

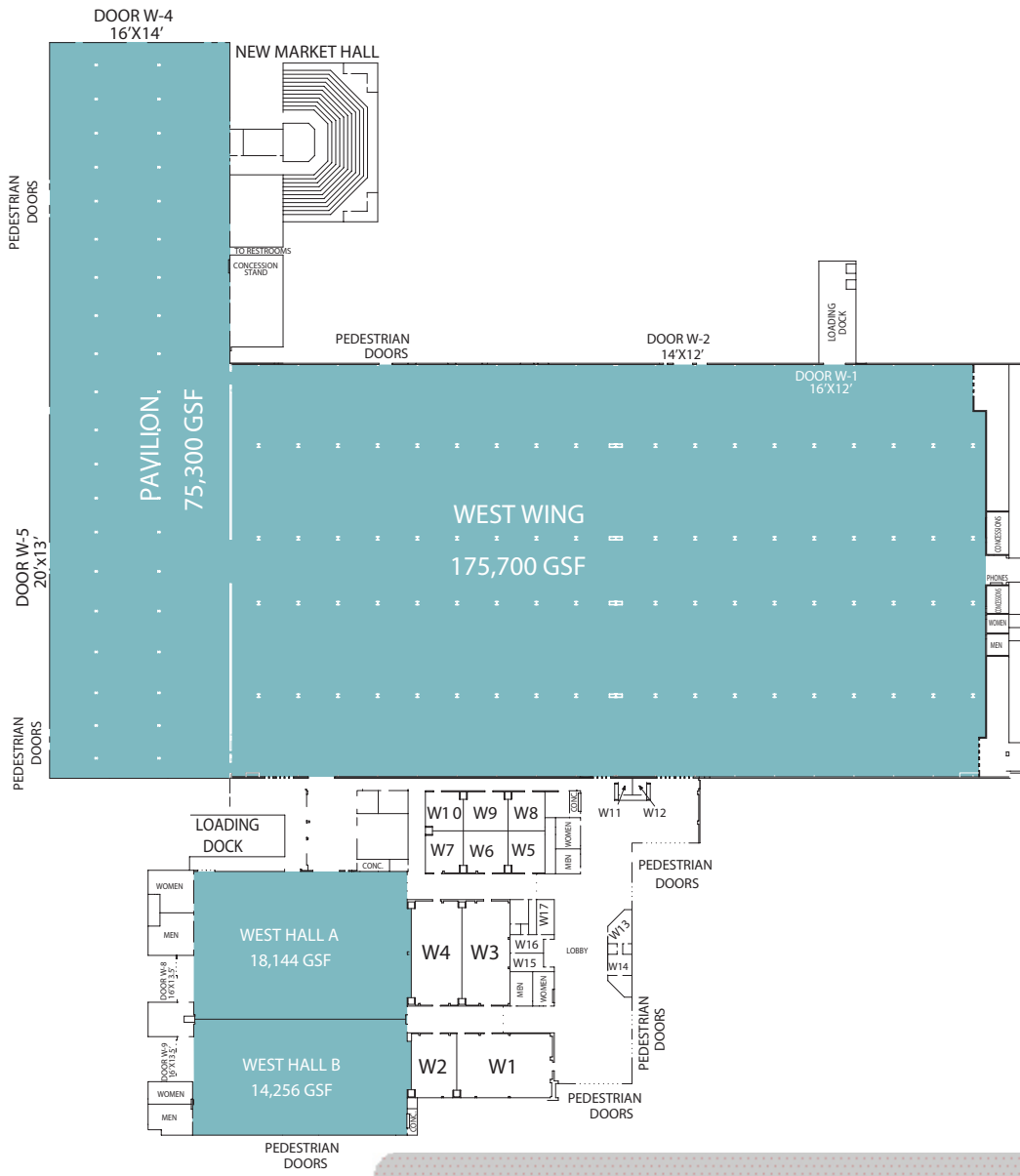

WEST WING	DIMENSIONS	TOTAL GSF	CEILING HEIGHT	THEATER STYLE	CLASSROOM/ BANQUET	10' X 10' BOOTHS
West Wing	311' x 565'	175,700	15' to 26'	5,400	5,400	1,050
Pavilion	136' x 554'	75,300	14' to 21'	1,800	1,800	381
West Hall A	112' x 162'	18,144	23'	2,400	1,213	98
West Hall B	88' x 162'	14,256	23'	1,200	934	75
West Hall AB	200' x 162'	32,400	23'	3,600	2,147	173
W1	48' x 74'	3,552	16'	507	237	20
W2	48' x 34'	1,632	16'	49	49	10
W3	38' x 78'	2,964	16'	423	198	14
W4	38' x 78'	2,964	16'	423	198	14
W5	30' x 30'	900	14'	49	49	NA
W6	30' x 30'	900	14'	49	49	NA
W7	30' x 30'	900	14'	49	49	NA
W8	30' x 30'	900	14'	49	49	NA
W9	30' x 30'	900	14'	49	49	NA
W10	30' x 30'	900	14'	49	49	NA
W1 - 2	48' x 108'	5,184	16'	740	346	30
W3 - 4	76' x 78'	5,928	16'	846	396	28
W5 - 8	30' x 60'	1,800	14'	256	120	NA
W6 - 9	30' x 60'	1,800	14'	256	120	NA
W7 - 10	30' x 60'	1,800	14'	256	120	NA
W5 - 10	60' x 90'	5,400	14'	768	360	NA
New Market Hall	Auditorium seating for 600.					

Floor load of West Wing, West Halls A & B and Pavilion is unlimited. Approximate GSF listed.

The Kentucky Exposition Center

P. O. Box 37130, Louisville, Kentucky 40233-7130

937 Phillips Lane, Louisville, Kentucky 40209

Phone: 502 367 5150 Fax: 502 367 5159

1 800 618 5151

[www.kyexpo.org](http://www.kyexpo.org)



**Kentucky Exposition Center**